

# Illusions 2.0 Monitor Hutch Instructions

951570-INST  
Rev. A

- 1.** There are two holes in the bottom panel of the monitor hutch for routing cords into the back cavity. Locate and cut holes into the base cabinets for wire management if needed.

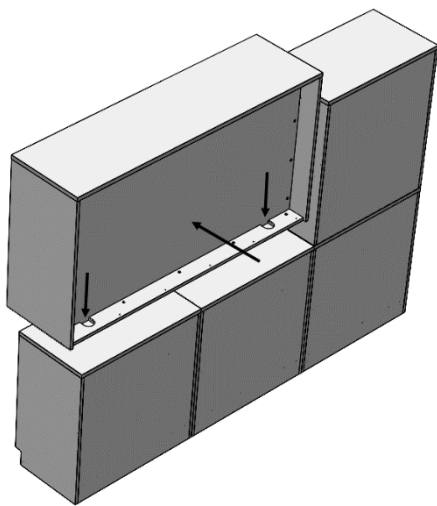

- 2.** We recommend installing monitor mount (not included) to the monitor hutch before installing on base cabinets. When installing monitor mount, we advise using bolts and nuts through the hutch back.

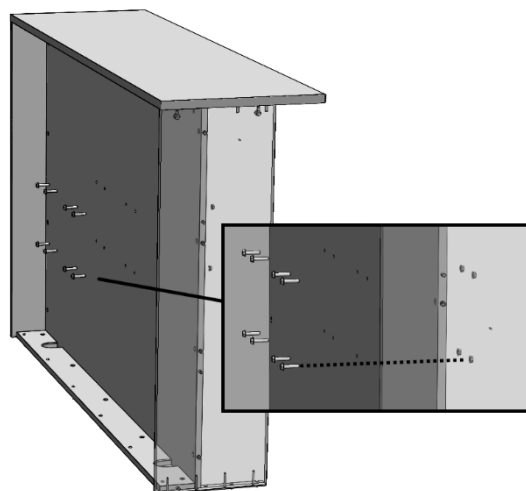

- 3.** Note that if sliding markerboards will be added, this will affect the opening size. See dimension below.

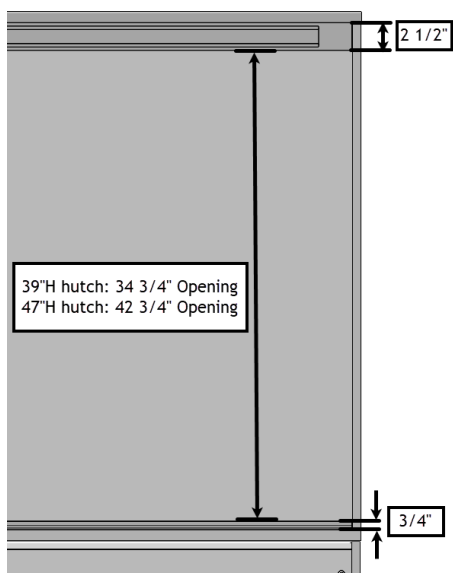

- 4.** Place all hutches on base cabinets and align.

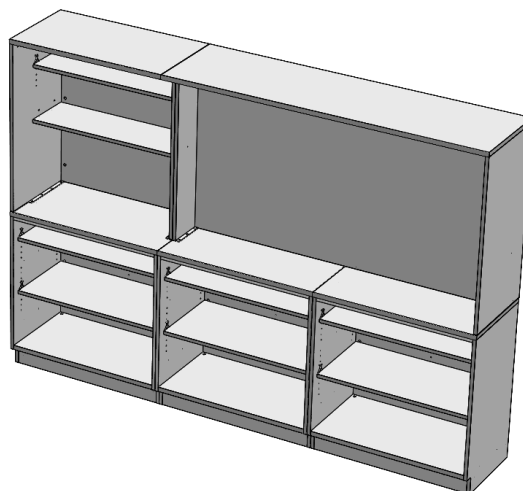

# Illusions 2.0 Monitor Hutch Instructions

951570-INST  
Rev. A

5. If monitor hutch is in a run with other hutches, clamp end panels to eliminate gaps between tops. Use the (4) #10 x 1.25 pan head wood screws to attach monitor hutch to adjacent cabinets through provided predrilled holes.

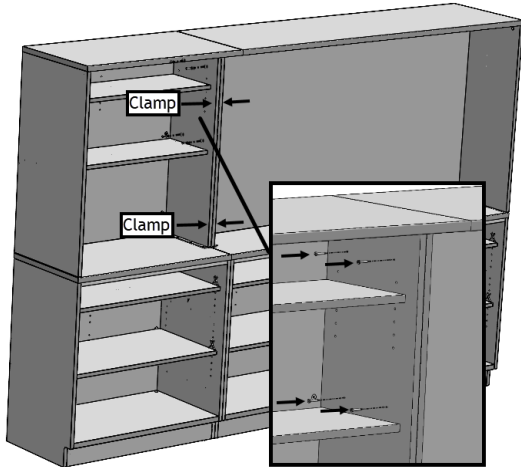

6. Use a 9/64" drill bit to predrill .5" deep holes into the base cabinet top, using the mounting plates as a guide.

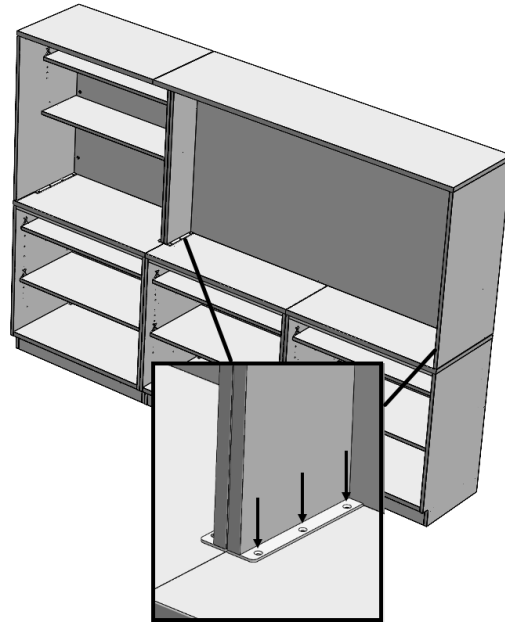

7. Attach the hutch to the base cabinet using (6) #10 x .750" flathead wood screws. Tighten to a torque of 30-35 in lbs.

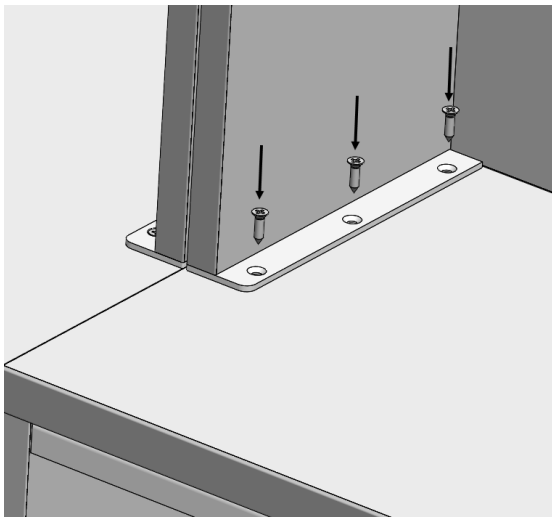

8. If monitor hutch is not attached to other hutches, additional screws need to be used to attach backside of hutch to base cabinet. Use a 9/64" drill bit to drill holes into the base cabinet through the holes in the hutch.

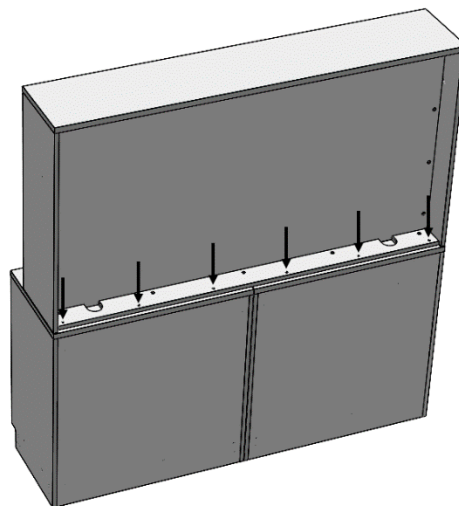

# Illusions 2.0 Monitor Hutch Instructions

951570-INST  
Rev. A

- 9.** Attach hutch to base cabinet using #10 x 1.5" Truss Head screws through predrilled holes. Tighten to a torque of 30-35 in-lbs.

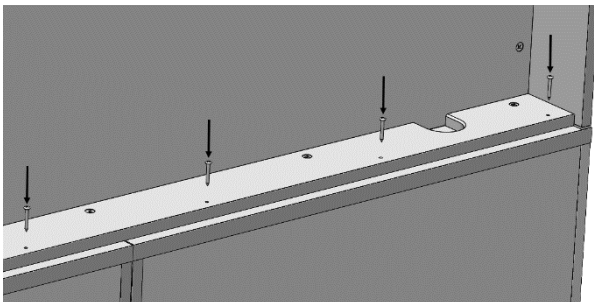

- 10.** If finished height of hutch is above 68" high, attach to wall per local codes and regulations.

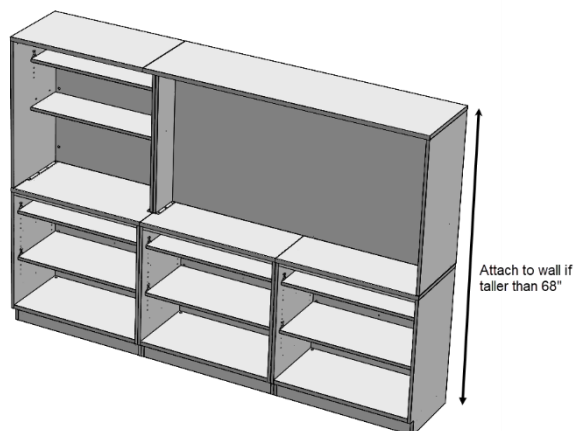

For questions please call us at (616) 396-1142