

1. Tilt cabinet and use Phillips drive to extend front levelers far enough down that hex feature is accessible with a wrench. Slide cabinet into position. Use a 7/8" flat wrench for final adjustments. Use 1/4" socket wrench with extension via back access holes to adjust back levelers.

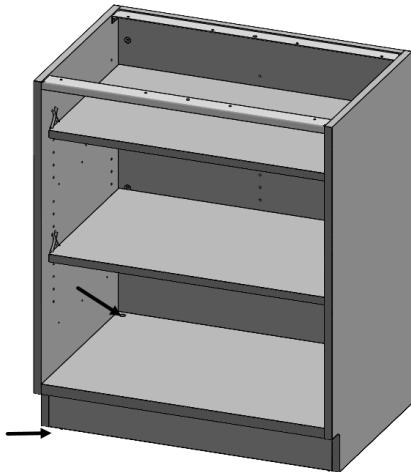

2. Extend front levelers on all additional cabinets and slide into position next to first cabinet. Using clamps, align tops of end panels. Adjust levelers as needed. If your cabinet has doors or drawers, it may help to remove these at this time. Be sure to track the position of each door and drawer so you can return it to its original location.

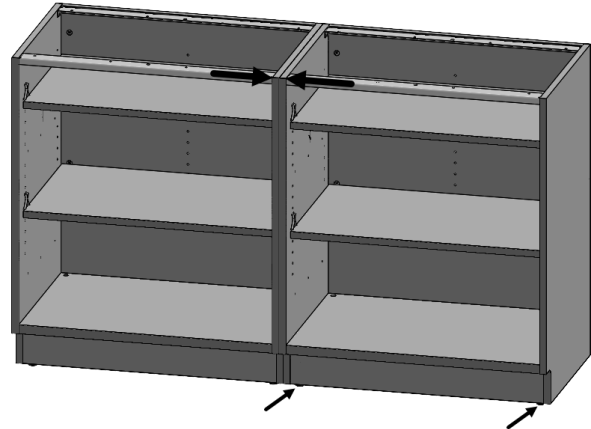

3. Use a 5/16" bit to drill through (4) partially predrilled pilot holes.

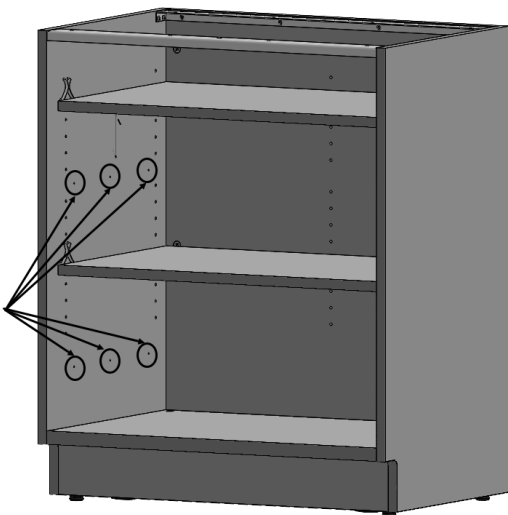

4. Install (4) connector bolts using a Phillips screwdriver to tighten as needed.

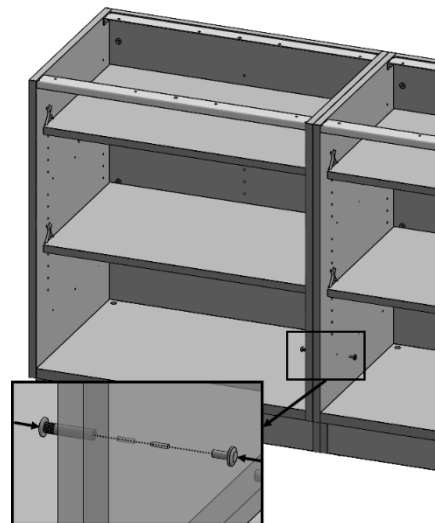

5. If cabinet has a spanning top, center it on the base cabinets so the overhang is equal on each side.

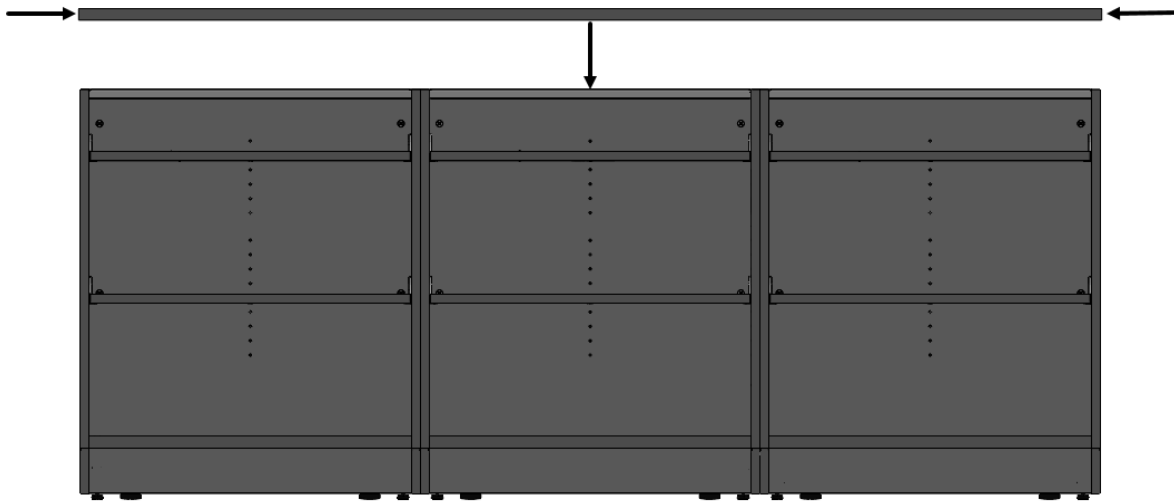

6. Using a 1/8" drill bit, predrill holes 1/2" deep to align with metal spanner holes in as many places as possible with minimum of (4) per cabinet. Use #10 x 0.625" screws to fasten top to base cabinets.

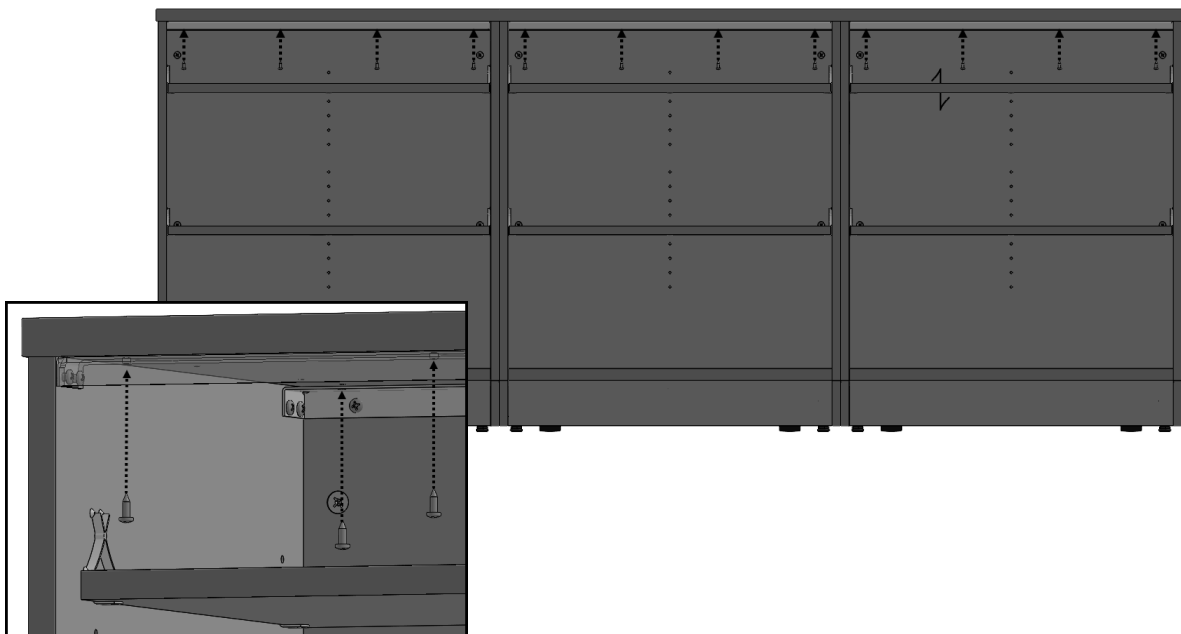

- 7.** If cabinet has a spanning backsplash, align it to the top and attach it to the wall with silicone adhesive.

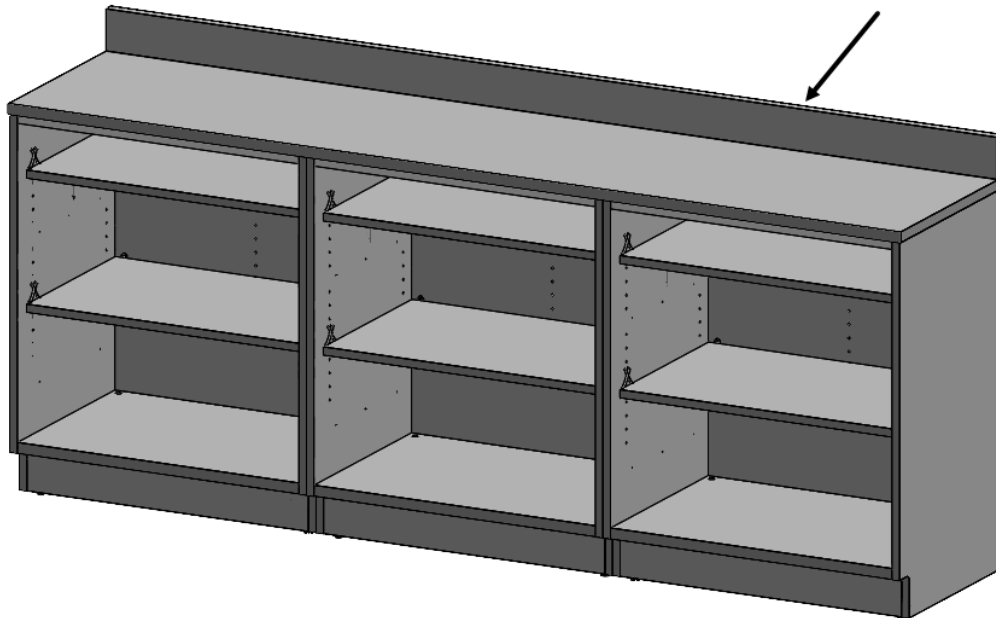

- 8.** All cabinets 18" wide or narrower must be attached to an adjacent cabinet.  
**9.** All cabinets taller than 68" should be attached to the wall per local codes and regulations.

For questions please call us at (616) 396-1142