

Double Sided Adder Library Shelf Instructions

934800-INST
Rev. B

- 1.** *This assembly requires two or more people to complete safely.* Complete steps 1-5 of the Double Sided Starter Library Shelf Instructions (934750-INST). Starter shelf required for adder assembly.

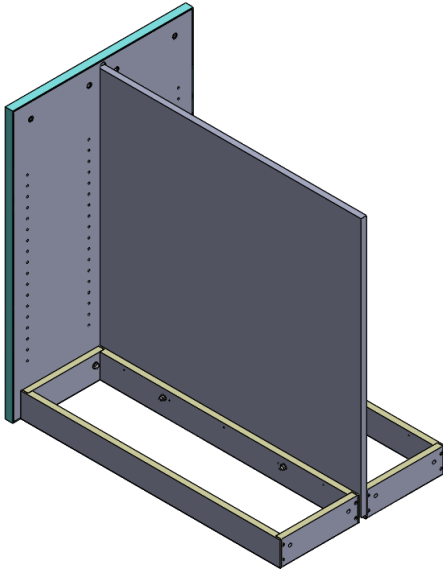

- 2.** Align (1) intermediate panel to the bottom box with the center panel in the intermediate panel groove.

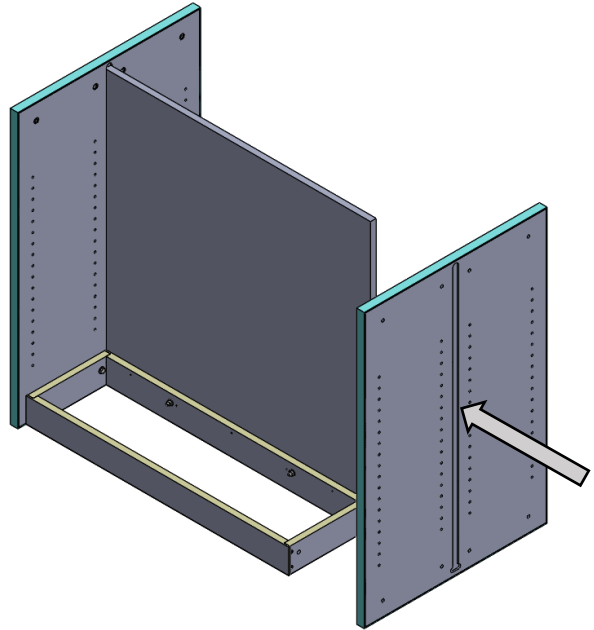

- 3.** Align (2) boxes against the bottom of the intermediate panel with the center panel mounting holes toward the center of the bookcase.

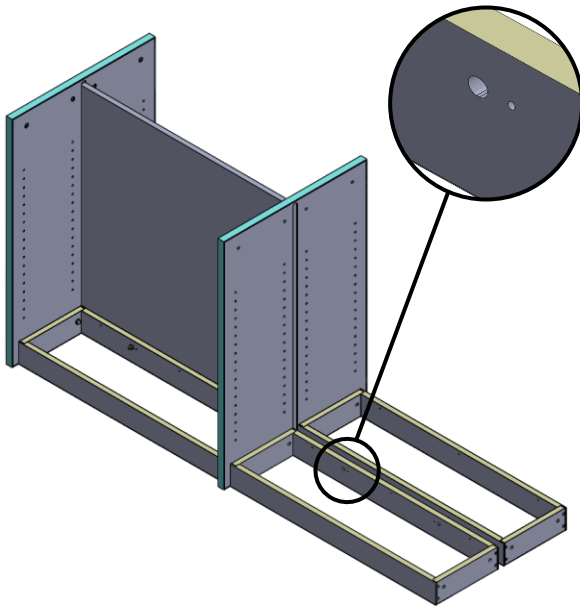

- 4.** Attach the boxes to the intermediate panel through the previous boxes using (4) 5/16-18 X 3" hex head bolts, (4) flat washers, and (4) flanged nuts. Hand tighten.

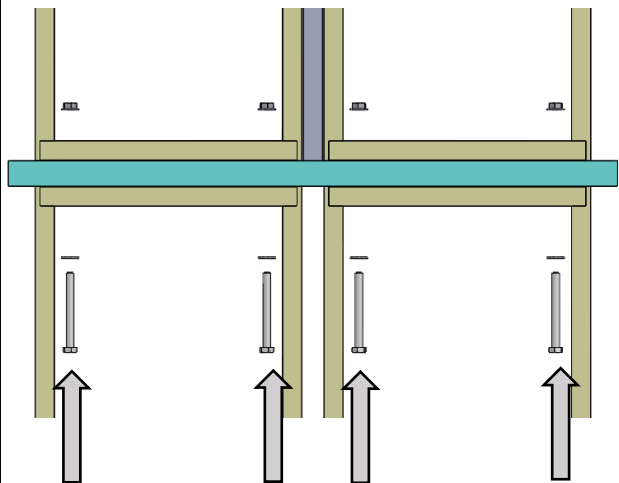

For questions please call us at (616) 396-1142

Double Sided Adder Library Shelf Instructions

934800-INST
Rev. B

- 5.** Slide (1) center panel into the groove in the intermediate panel with holes toward the bottom of the bookcase.

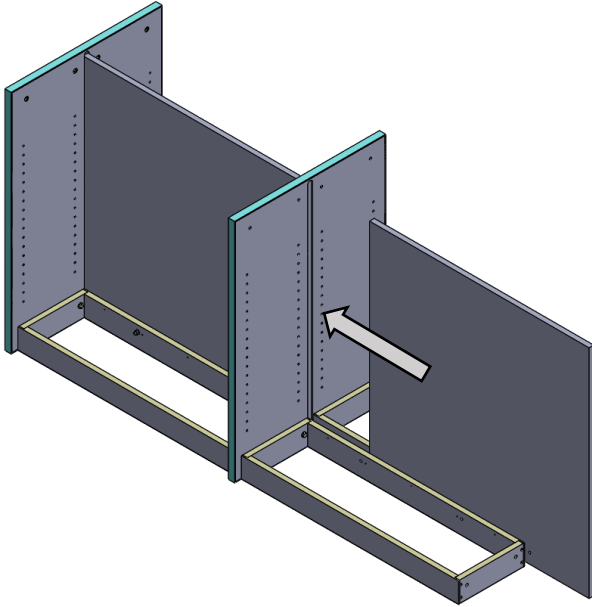

- 6.** Attach the center panel with (2) 5/16 X 3" hex bolts, (2) flat washers, and (2) flanged nuts using the two larger holes on the panel and boxes. Tighten to a torque of 50-60 in-lbs.

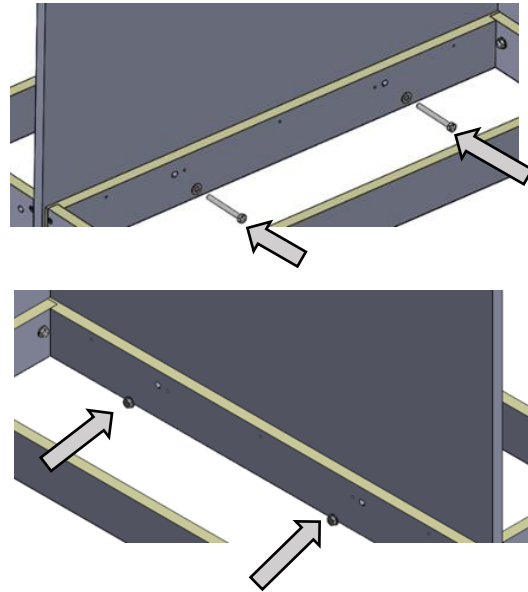

- 7.** Repeat steps 2-6 until all adders have been set up. Then, screw the bottom screw of (6) 90-degree brackets into each of the remaining boxes using (6) #10 X 0.625" screws. Tighten to a torque of 30-35 in-lbs.

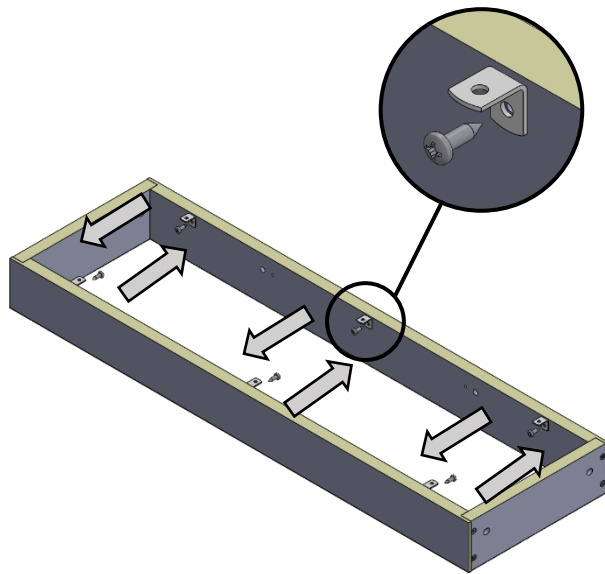

- 8.** Align the right hand end panel to the last bottom boxes with the center panel in the end panel groove. Attach the end to the bottom boxes using (4) 5/16-18 X 1.5" hex head bolts and (4) washers. Hand tighten.

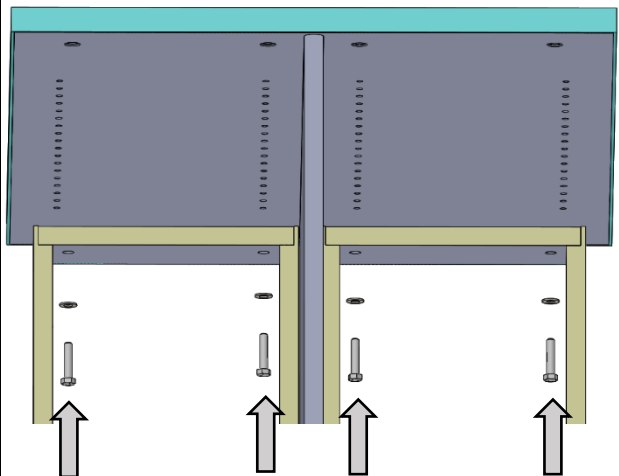

For questions please call us at (616) 396-1142

Double Sided Adder Library Shelf Instructions

934800-INST
Rev. B

- 9.** Align (1) box with brackets inside each shelf with back panel mounting holes toward the center of the bookcase and edgeband facing down.

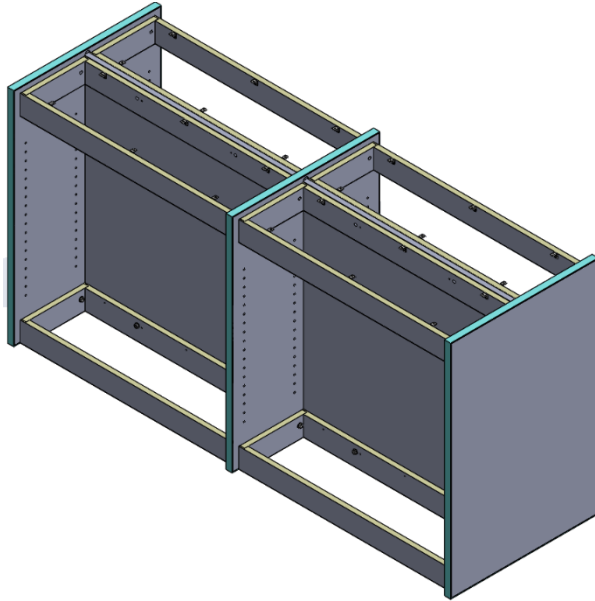

- 10.** Attach the first and last boxes to the end panels using (8) 5/16-18 X 1.5" hex head bolts and (8) flat washers. Hand tighten.

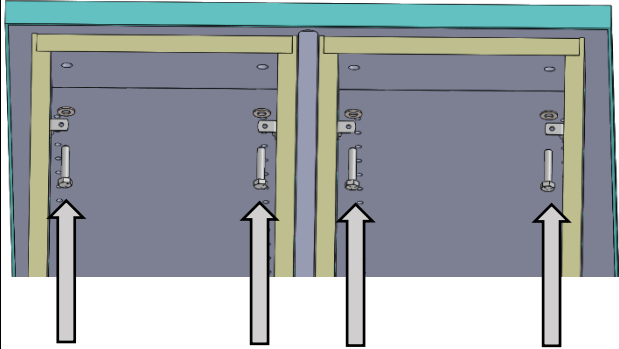

- 11.** Attach each top box to intermediate panels through the previous box using (2) 5/16-18 X 3" hex bolts, (2) flat washers, and (2) flanged nuts. Hand tighten until tops are installed.

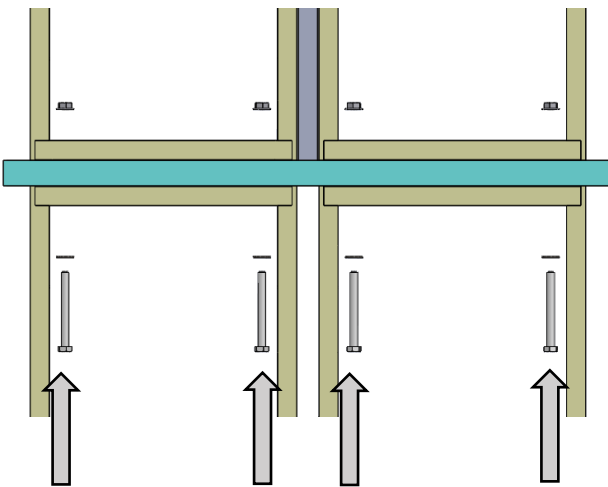

- 12.** Place (1) top panel on each unit with the hole side facing down. Attach each top panel to the brackets using (12) #10 X 0.625" screws. Tighten to a torque of 30-35 in-lbs. Then tighten all end/intermediate hex head bolts to a torque of 50-60 in-lbs.

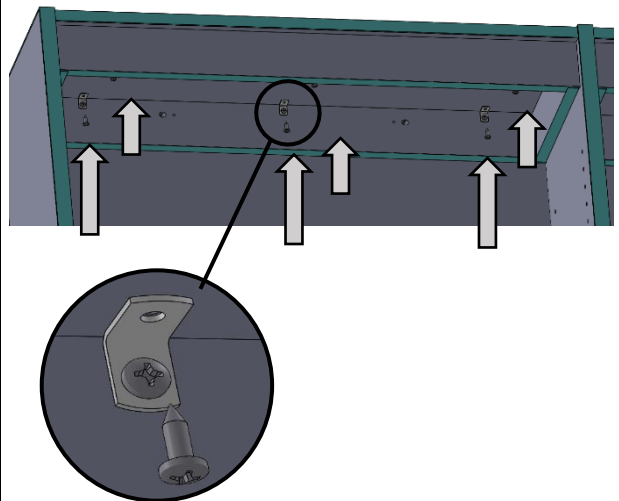

For questions please call us at (616) 396-1142

Double Sided Adder Library Shelf Instructions

934800-INST
Rev. B

- 13.** If shelves are 60" or 72" high, complete this step. Attach (1) 90-degree bracket with (2) #10 X 0.625" screws to each of the inside support locations. Tighten to a torque of 30-35 in-lbs.

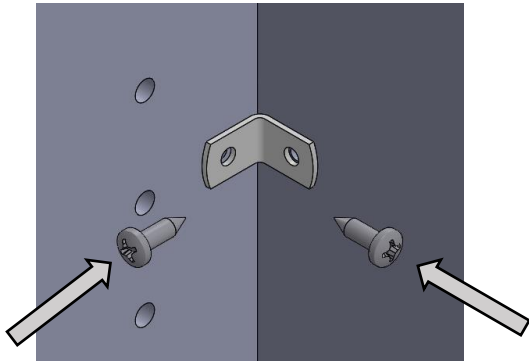

- 14.** Install (1) lower shelf on the top of each bottom box with the bumpers down and facing out of the bookcase.

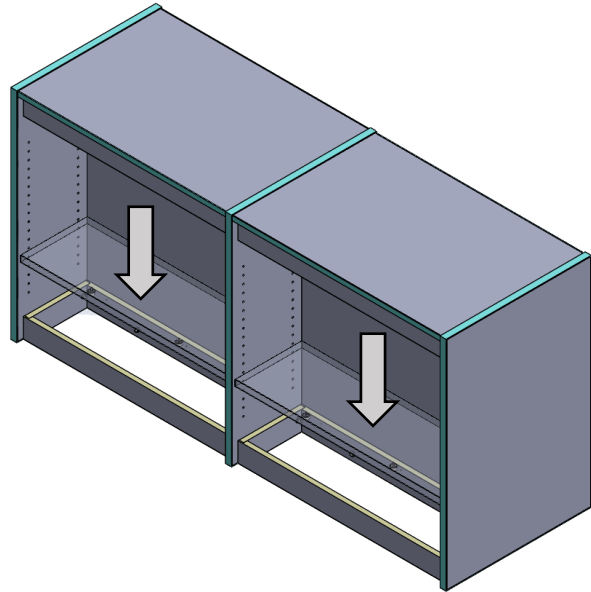

- 15.** Insert (4) shelf clips for each shelf into the panel holes at the desired height. Use 90-degree clips for wood shelves and 45-degree clips for metal shelves.

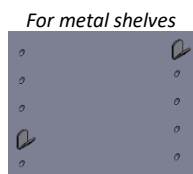
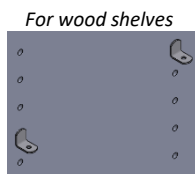
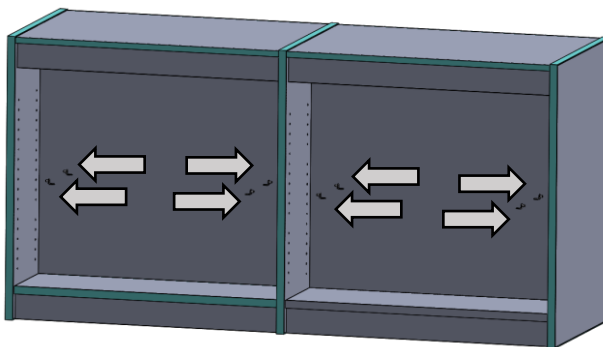

- 16.** Install shelves on clips. If installing reinforced shelves, install with reinforcement down and facing out. If installing metal shelves, install with flat back against the back panel.

Standard/Reinforced Shelf

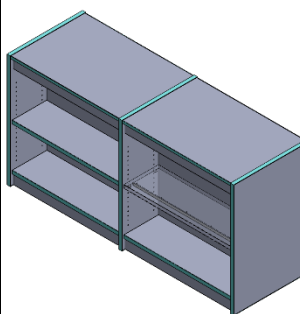

Metal Shelf

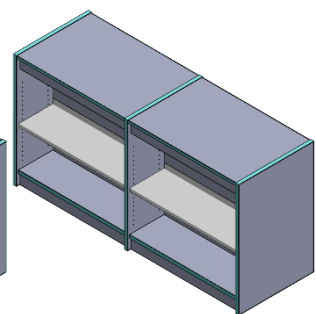

For questions please call us at (616) 396-1142