

PERSPECTIVE VIEW

STM.DEM.CLS.01

STEM.Demonstration.Clusters.#1

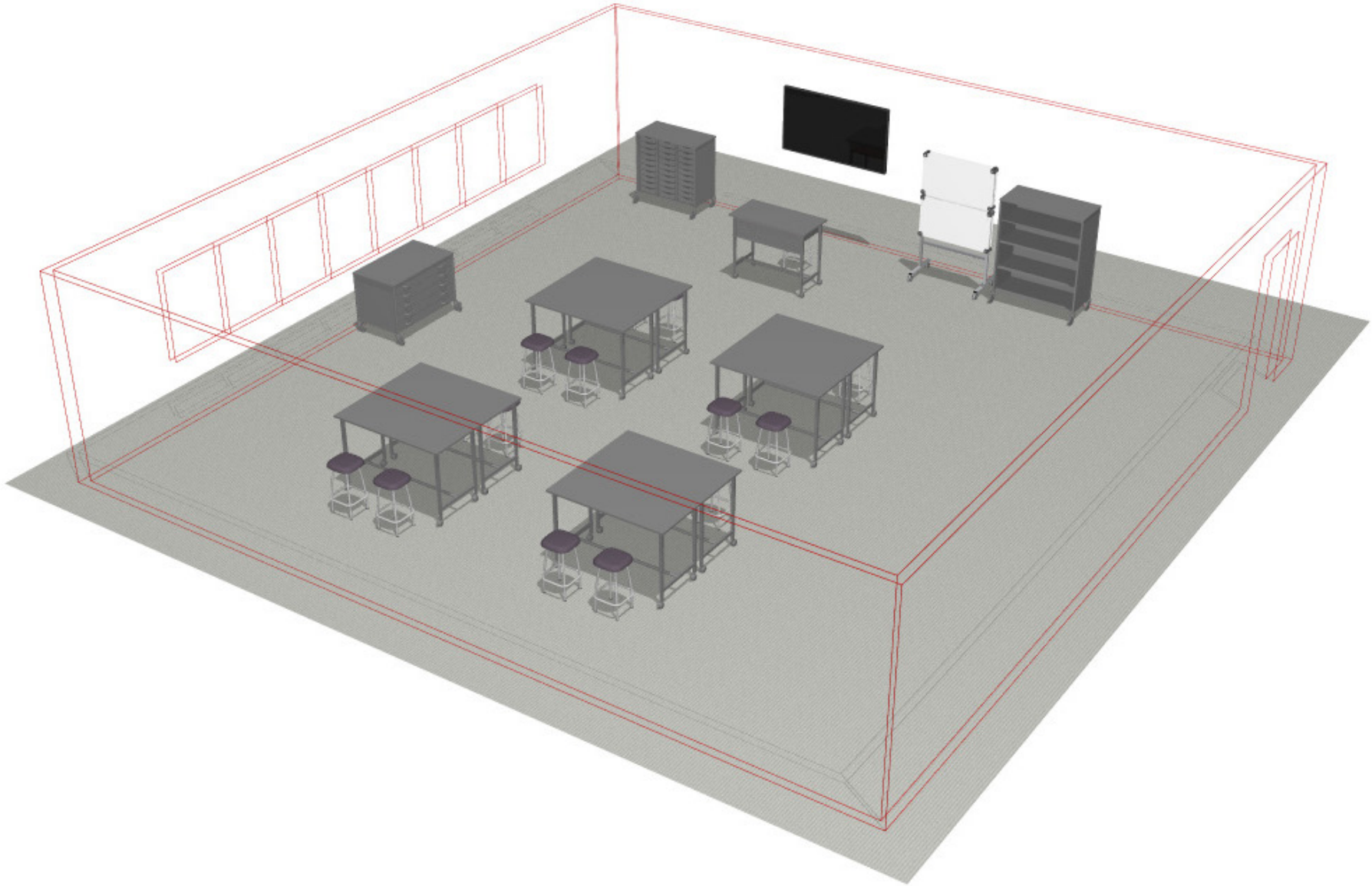

Fleetwood®

For help creating your effective learning environment,
contact us at 616.396.1142 or sales@fleetwoodfurniture.com

PLAN VIEW

STM.DEM.CLS.01

STEM.Demonstration.Clusters.#1

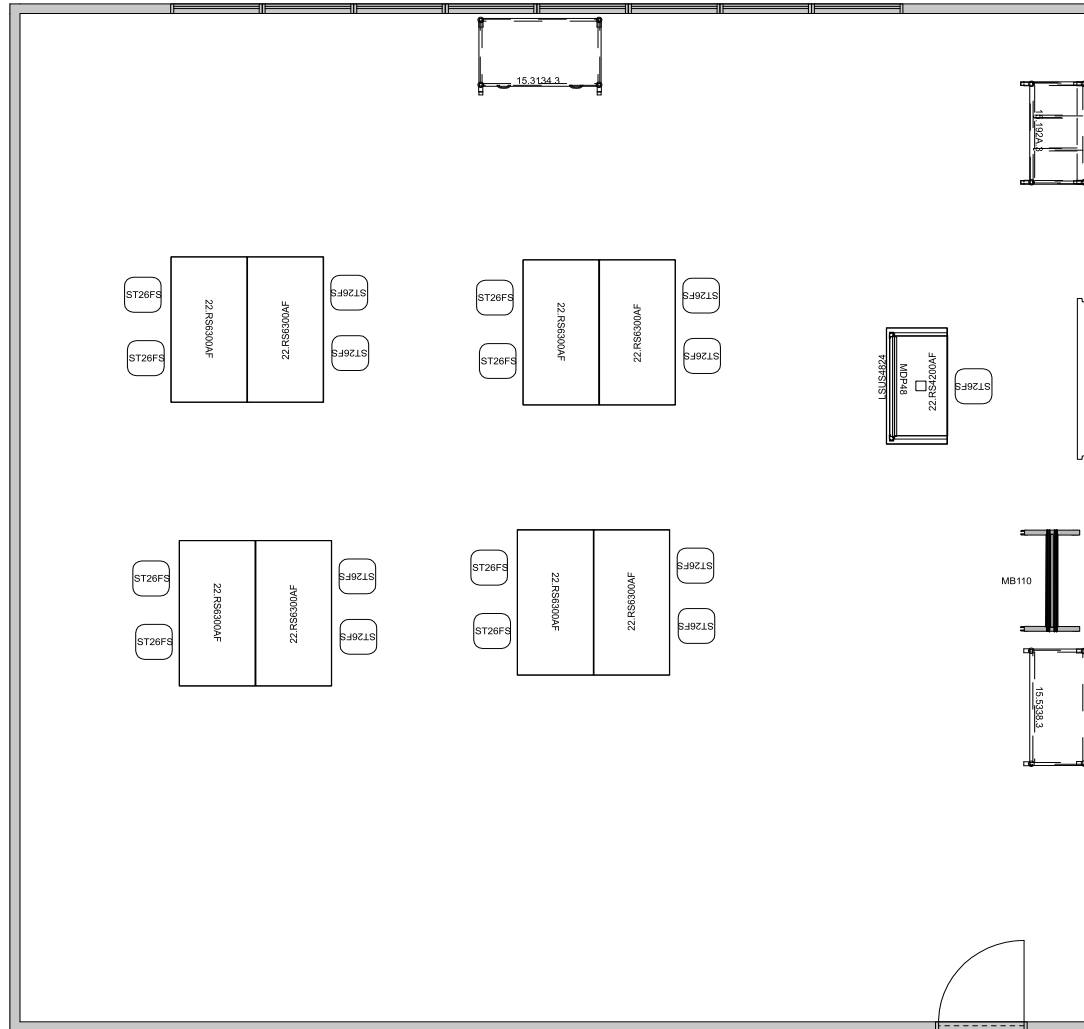

STM.DEM.CLS.01

Scale: 1:60

PRODUCT LIST

STM.DEM.CLS.01

STEM.Demonstration.Clusters.#1

PART NUMBER	DESCRIPTION	QTY	LIST	EXT. SELL
ST26FS	Rock Active Seating Stool Dark Graphite Seat Levelers 13.5w 26h 13.5d	17	\$300	\$5,100
MDP48	Perforated Steel Modesty Panel Installed at the factory	1	\$110	\$110
MB110	Pages Horizontal Cart with 4 Pages Boards 75mm Locking Casters 42w 72h 22d	1	\$1,030	\$1,030
LSUS4824	Under Worksurface Shelf Laminate Shelf with Center Support Installed at the factory. Shelf color is Etched Gray	1	\$214	\$214
22-RS630F	Rectangle Table, Unitized Frame, Square Legs, 3/4"thick worksurface, Adjustable Height - H-Leg with Foot Rail 75mm Casters 60w x 34-42h x 30d	8	\$764	\$6,112
22-RS420F	Rectangle Table, Unitized Frame, Square Legs, 3/4"thick worksurface, Adjustable Height - H-Leg with Foot Rail 75mm Casters 48w x 34-42h x 24d	1	\$626	\$626
15-5338-3	Sheerline Collection Tall Storage 3 Adjustable Shelves No Doors 2 Locking & 2 Non-Locking 5"Casters 48w x 60h x 22	1	\$1,510	\$1,510
15-3134-3	Sheerline Collection Low Drawer Storage 5 Non-Locking Drawers with 96mm Arch Pull 2 - Locking & 2 Non-Locking 5"Casters 48w x 34.25h x 28d	1	\$1,790	\$1,790
15-192	Sheerline Collection Mid Tray Storage holds up to 30 Gratnells Trays No Doors 2 Locking & 2 Non-Locking 5"Casters 42w x 44h x 22d	1	\$1,926	\$1,926

Total FLEETWOOD - \$18,418.00

RENDERING

STM.DEM.CLS.01

STEM.Demonstration.Clusters.#1

